

# DC RANCH DESERT CAMP

## PLANTING ZONES



### NATURAL ZONE

- Mimics the natural desert
- Plant density = 1:25 sq. ft.
- Base shrub requirements are listed in the Abbreviated Plant Palette in this booklet.

### BLOCK WALL



### PRIVATE ZONE

- Behind 5 ft. high privacy wall
- Back yards which are not completely enclosed by a 5 ft. solid block wall may use private zone plants, provided that along the perimeter of the view fence an enhanced zone is utilized.
- Behind a 5 ft. privacy view fence. (The area from the fence to 5 ft. away is Enhanced Zone)
- Plant density = 1:25 sq. ft.
- No base shrub requirements



### ENHANCED ZONE

- All non-enclosed areas from face and side walls of the home to where it meets natural zone.
- Plant density = 1:25 sq. ft.
- Base shrub requirements are listed in the Abbreviated Plant Palette in this booklet.

MARKET STREET VILLAS  
COURTYARDS AT MARKET STREET\*  
VILLAGE AT MARKET STREET\*  
THE VILLAS AT DESERT CAMP\*  
PIONEER  
MONTELANA  
CAMELOT  
ROSEWOOD  
THE HACIENDAS

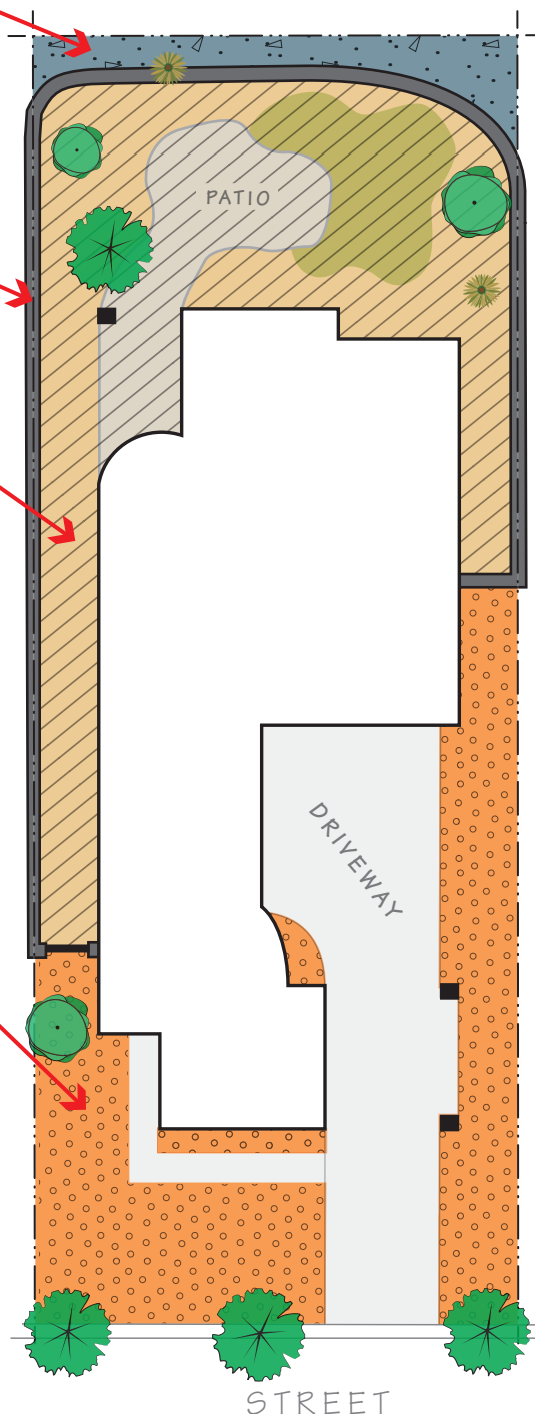

NOTE: Zone maps are for illustration purposes only and do not represent specific lots, nor any requirements for plant species, location or quantities.  
\* Subassociations may differ; check with property management on homeowner responsibility and additional restrictions.

## Abbreviated Plant Palette

### DESERT CAMP

#### Private Zone

Trees – Pendulous Acacia, Chilean Mesquite, Cascalote, Anacacho Orchid Tree, Desert Willow Hybrids, Swan Hill Olive, Mastic, Western Redbud  
Cacti/Accents – Pendulous Yucca, Tropical Agave, Octopus Agave, Moroccan Mound  
Shrubs (large) – Japanese Mock Orange, Bird of Paradise, Pineapple Guava, Cape Honeysuckle, Heavenly Bamboo  
Shrubs (med/small) – Dwarf Natal Plum, Cape Plumbago, Dwarf Bottlebrush, Damianita, Dwarf Mock Orange  
Groundcovers – Rain Lily, Wedelia, Asian Jasmine, Cape Plumbago, Vinca, Elephant Food, Bulbine, Prostrate Acacia, Ground Morning Glory  
Vines – Common Trumpet Creeper, Creeping Fig, Cat's Claw Vine, Queens Wreath

#### Enhanced Zone

Trees – Texas Ebony, Hybrid Palo Verde, Palo Blanco, Chaste Tree, Mulga, Western Redbud  
Cacti /Accents– Parry's Agave, Red Yucca, Golden Barrel, Blue Glow Agave, Butterfly Agave, Totem Pole Cactus  
Shrubs (large) – Hopseed Bush, Texas Sage, Woolly Butterfly Bush, Mexican Bird of Paradise, Bush Lantana  
Shrubs (med/small) –**Base Shrub Requirement**- 1 of every 6 plants must be Bursage, and 1 of 6 may be any combination of Bursage, Desert Marigold or Turpentine. Additional choices for this zone include: Baja Ruellia, British Ruellia, Dwarf Yaupon Holly, Mexican Blue Sage, California Fuchsia, Coral Fountain, Angelita Daisy, Cleveland Sage  
Groundcovers – Trailing Lantana - purple, Mexican Evening Primrose, Dwarf Rosemary, Desert Marigold, Rail Lily, Sierra Gold Dalea, Saltillo Primrose, Dyssodia, Blackfoot Daisy, Goodding's Verbena  
Vines – Lilac Vine, Pink Trumpet Vine, Lady Bank's Rose, Queens Wreath

#### Natural Zone

Trees – Ironwood, Velvet Mesquite, Blue Palo Verde  
Cacti/Accents – Saguaro, Engelmann's Prickly Pear, Buckhorn Cholla, Ocotillo, Fire Barrel, Pincushion Cactus  
Shrubs (large) – Creosote, Jojoba, Desert Lavender, Wolfberry, Chuparosa, Desert Hackberry  
Shrubs (med/small) – **Base Shrub Requirement** – 1 of every 6 plants must be Bursage, and 1 of 6 may be any combination of Bursage, Desert Marigold or Turpentine. Additional choices for this zone include: Desert Globemallow, Goldeneye, Joint Fir, Canyon Ragweed, Trixis  
Groundcovers – Dyssodia, Blackfoot Daisy, Goodding's Verbena  
Vines – Queens Wreath

- See DC Ranch Design and Construction Manual book for a complete list of over 300 plant species available.
- Consult Environmental Site Plan (ESP) for designated street tree